

SportDesign Package (I-no. XAT)

Revision: This bulletin replaces bulletin Group 6, #14/15, dated November 2, 2015.

Model Year: **As of 2015 up to 2016**

Vehicle Type: **911 Carrera GTS (991)/911 Carrera 4 GTS (991)**

Concern: **Retrofitting**

Note: The "SportDesign package" comprises the following components:

- New rear spoiler
- Air intake grille (rear lid)
- Specially adapted control unit for air deflector (**ONLY** for vehicles with sliding roof = I-no. 651/glass sunroof = I-no. 653)

The components have been tested and approved together. Fitting of individual components is not permitted or approved! The button for controlling the rear spoiler manually in the center console still has NO function in the vehicle.

The "SportDesign package" (⇒ *Figure 1*) is also available as a factory installed option for new vehicles by requesting optional equipment "XAT".



Figure 1

Parts Info: **991.044.800.78** ⇒ SportDesign package –prime coated–, set

ONLY for vehicles with sliding roof/glass sunroof - also order the following:

991.618.217.00 1 x ⇒ Control unit for air deflector

Parts List:

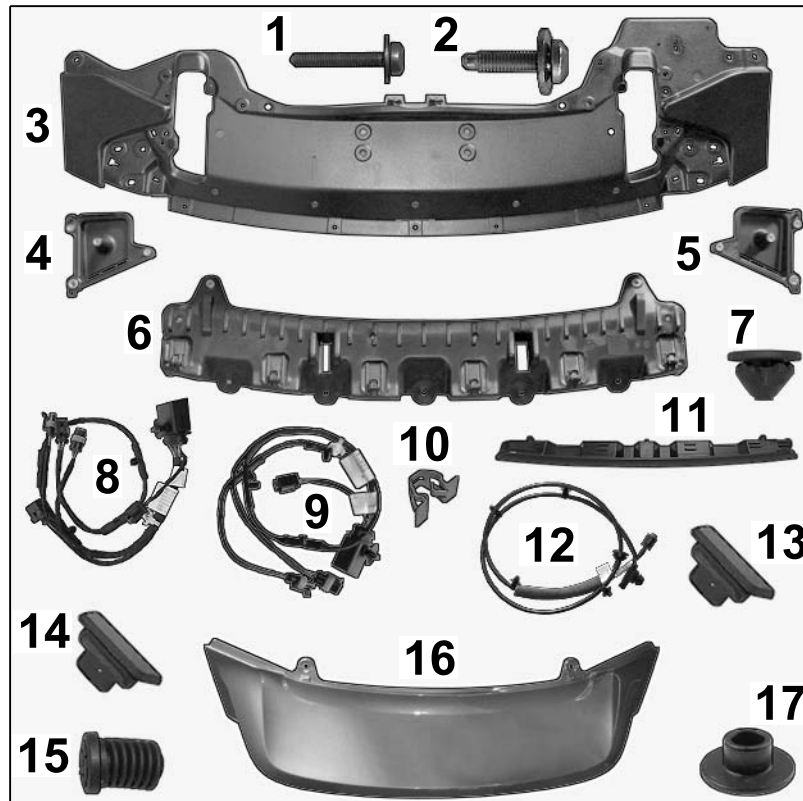

Figure 2

N .911.657.01	8 x	Combination screw, M6 x 35 TC ⇒ Figure 2 -1-
999.073.223.01	9 x	Combination screw, M6 x 25 PA ⇒ Figure 2 -2-
991.504.999.00	1 x	Mounting bracket –black– (metal) ⇒ Figure 2 -3-
991.504.965.00.1E0	1 x	Water drip pan, left ⇒ Figure 2 -4-
991.504.966.00.1E0	1 x	Water drip pan, right ⇒ Figure 2 -5-
991.504.998.01	1 x	Mounting adapter –black– (plastic) ⇒ Figure 2 -6-
958.110.673.00	2 x	Rubber mounting (for mounting ball joint) ⇒ Figure 2 -7-
991.612.884.00	1 x	Wire harness for mounting bracket; Coupé ⇒ Figure 2 -8-
991.612.884.50	1 x	Wire harness for mounting bracket; Cabriolet ⇒ Figure 2 -9-
999.507.584.01	2 x	Clamp, 8.0 x 10.2/2.0 (for securing 3rd brake light) ⇒ Figure 2 -10-

Tools:	Nr. 90 Pos. 1 - Torque wrench	Gap dimension gauge
	9900 - PIWIS Tester 3	Shop light
	Nr. 124-1 - Hand riveting tool for pop rivets	T10118 - Assembly tool

Work Procedure: 1 Preparatory work

CAUTION

Painting components

- Risk of warping of components
 - Risk of damage to components
- ⇒ Observe the guidelines and instructions for painting components in the "Paint" Workshop Manual.
- ⇒ Always place parts without tension on the painting devices provided during painting and drying processes.

- 1.1 Paint all prime-coated parts to match the vehicle's colour code in accordance with the "Paint Manual".
- 1.2 Connect battery charger (⇒ *Workshop Manual '2X00IN Battery trickle charging*).
- 1.3 Remove rear spoiler (⇒ *Workshop Manual '66581905 Removing and installing rear spoiler*).

- 2 **ONLY** for vehicles with sliding roof/glass sunroof:
Replace control unit for air deflector (⇒ *Figure 3*)
Remove standard control unit for air deflector and install new control unit for air deflector (⇒ *Workshop Manual '606619 Removing and installing control unit for air deflector*)

- 3 Complete and assemble new rear spoiler
 - 3.1 Complete the mounting bracket

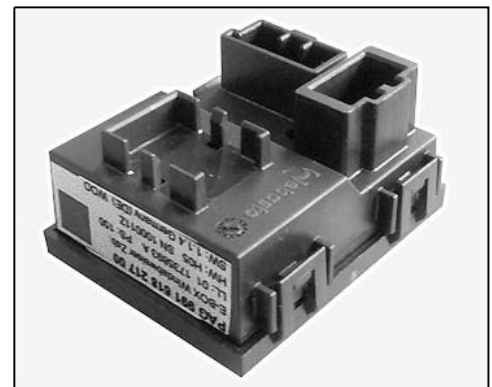

Figure 3

3.1.1 Fit two rubber mountings in the mounting bracket (right: ⇒ *Figure 4 -inset-*).

- 1 – Rubber mounting (for mounting ball joint)
- 2 – Mounting bracket

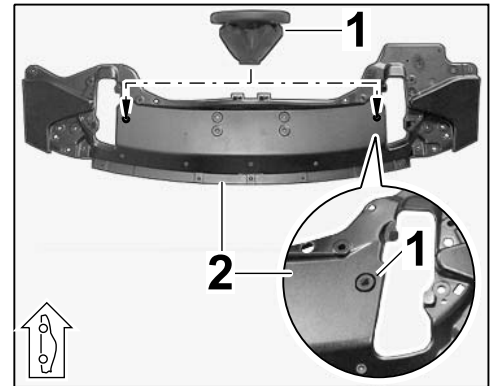

Figure 4

3.1.2 Position mounting adapter on mounting bracket (⇒ *Figure 5 -arrow-*).

- A – Upper side
- B – Lower side
- 1 – Mounting adapter
- 2 – Mounting bracket
- 3 – Combination screw, M6 x 25 PA

Fit four combination screws (M6 x 25 PA) through the mounting bracket on the mounting adapter from below and tighten securely.
Tightening torque 9.7 Nm (7.5 ftlb.)

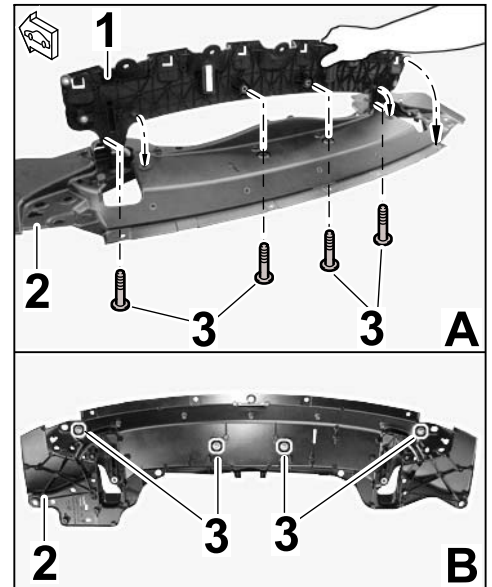

Figure 5

- 3.1.3 Position water drip pan (left: ⇒ *Figure 6 -inset-/right*) on the underside of the mounting bracket in such a way that the pin on the water drip pan (⇒ *Figure 6 -inset, arrow-*) engages in the bore on the mounting bracket.

- A** – Lower side
B – Upper side
1 – Water drip pan, left
2 – Water drip pan, right
3 – Combination screw, M6 x 35 TC
4 – Mounting adapter
5 – Mounting bracket
6 – Combination screw, M6 x 25 PA

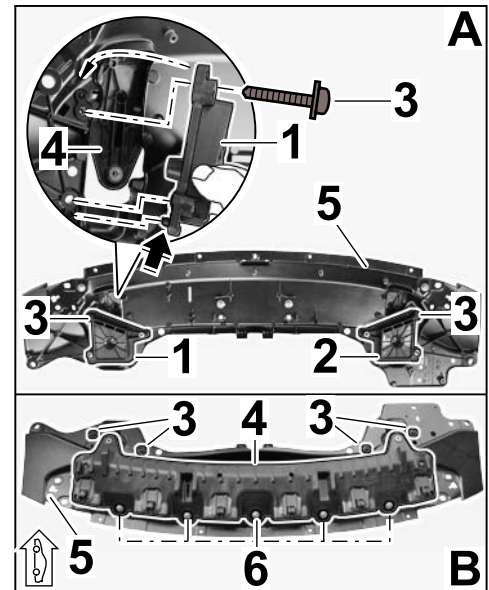

Figure 6

Loosely pre-fit the water drip pan (at the left/right) using one combination screw (M6 x 35 TC, ⇒ *Figure 6 -A3-*) on each side (⇒ *Figure 6 -4-*).

- 3.1.4 Turn the mounting bracket on the upper side (⇒ *Figure 6 -B-*) and secure the water drip pan (at the left/right) using two combination screws (M6 x 35 TC, ⇒ *Figure 6 -B3-*).

Tighten three combination screws (M6 x 35 TC; water drip pan, left/right ⇒ *Figure 6 -3-*) on the upper/lower side of the mounting bracket.

Tightening torque 9.7 Nm (7.5 ftlb.)

- 3.1.5 Secure mounting adapter to the mounting bracket using five combination screws (M6 x 25 PA; ⇒ *Figure 6 -B-*).

Tightening torque 9.7 Nm (7.5 ftlb.)

3.1.6 Convert rubber mounting, left/right (2 ea.) for pins on engine compartment trim at the left/right (right side: ⇒ *Figure 7*).

- 1 – Rubber mounting, right (engine compartment trim)
- 2 – Rubber mounting, centre right (engine-compartment blower)
- 3 – Mounting bracket
- 4 – Mounting adapter

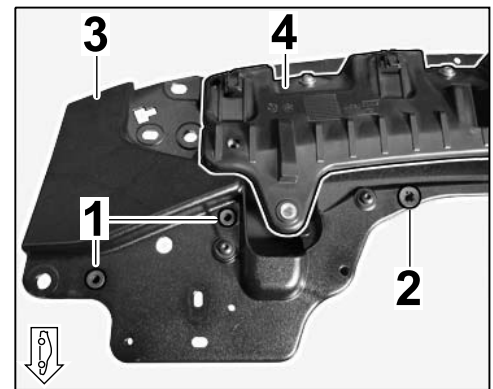

Figure 7

Convert two rubber mountings at the centre for pins on engine-compartment blower (right side: ⇒ *Figure 7*).

3.1.7 **ONLY** for Coupé: Convert cover for lower part of lid lock with lower part of rear lid lock (⇒ *Workshop Manual '558619 Removing and installing lower part of rear lid lock'*).

Tightening torque 9.7 Nm (7.5 ftlb.)

- 1 – Cover on lower part of lid lock, rear
- 2 – Lower part of lid lock, rear
- 3 – Lid-release motor, rear
- 4 – Speed nut, ST 4.8
- 5 – Lower side of mounting bracket

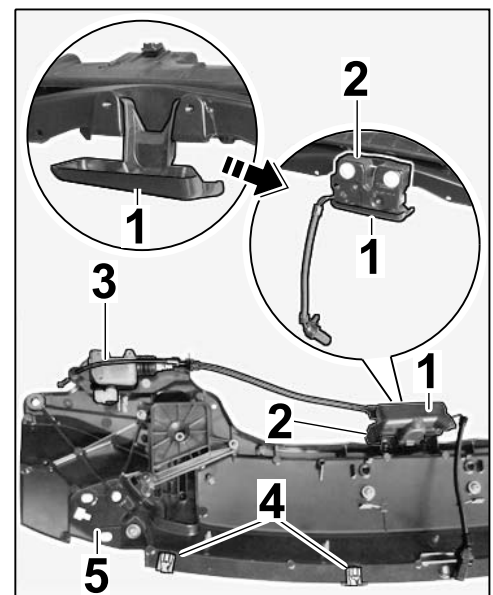

Figure 8

Convert rear lid-release motor with retaining bracket (⇒ *Workshop Manual '558419 Removing and installing rear lid-release motor'*, ⇒ *Figure 8*).

Tightening torque 9.7 Nm (7.5 ftlb.)

3.1.8 **ONLY** for Cabriolet: Convert convertible-top compartment lid centering device (similar to: ⇒ *Figure 8-2-*).

Tightening torque 9.7 Nm (7.5 ftlb.)

3.1.9 Convert two centering journals (⇒ *Figure 10-1-*) on mounting bracket.

3.2 Route and connect electric wire harness on the mounting bracket

3.2.1 Connection diagram

- A** – Electric wire harness - Cabriolet
- B** – Electric wire harness - Coupé
- 1** – Connector for vehicle wire harness
- 2** – Connector for additional brake light
- 3** – Connector for engine-compartment blower
- 4** – Connector for (rear) lid-release motor; Coupé ONLY
- 5** – Connector for lower part of lid lock; Coupé ONLY
- arrows** – Retaining clip

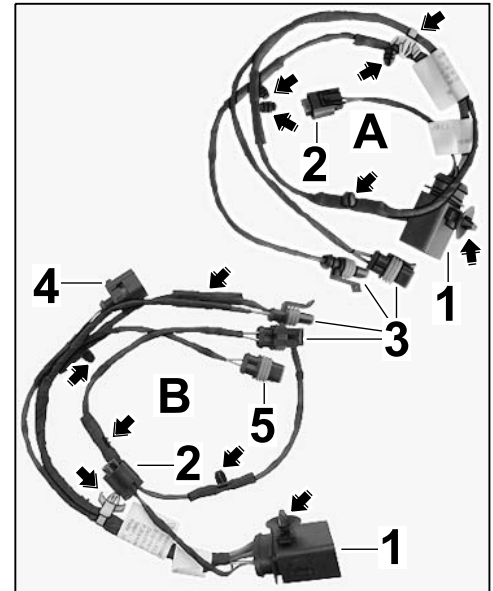

Figure 9

3.2.2 Position electric wire harness on the mounting bracket and secure with four retaining clips (⇒ Figure 10 -arrows-).

- 1** – Centring journal
- 2** – Plug connection for (rear) lid-release motor; Coupé ONLY
- 3** – Plug connection for lower part of (rear) lid lock; Coupé ONLY
- 4** – Connector for engine-compartment blower
- 5** – Connector for additional brake light
- 6** – Connector for vehicle wire harness

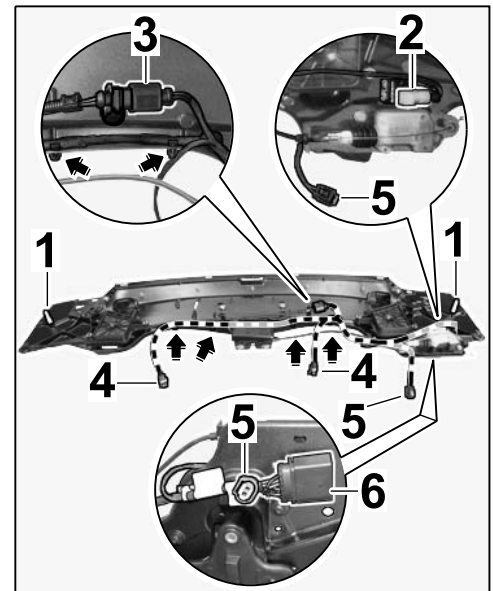

Figure 10

Connect plug connections and secure on the mounting bracket (⇒ Figure 10).

3.3 Install additional brake light trim in air intake grille (rear lid)

3.3.1 Remove air intake grille (rear lid) with bracket (⇒ Workshop Manual '665619 Removing and installing air intake grille (rear lid)).

Fit new air intake grille (rear lid) on bracket and install it.

3.3.2 Insert additional brake light connector, which is no longer required, (Coupé: rear lid or Cabriolet: convertible-top compartment lid) in the additional brake light trim (⇒ *Figure 11 -A-*).

- 1 – Connector for additional brake light (rear lid/convertible-top compartment lid)
- 2 – Additional brake light trim
- 3 – Rear lid

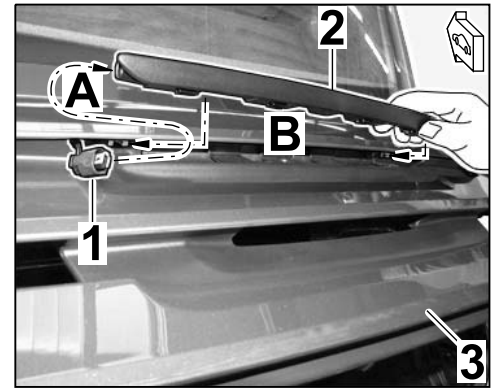

Figure 11

3.3.3 Fit trim in the rear lid/convertible-top compartment lid (⇒ *Figure 11 -B-* ⇒ *Workshop Manual '947019 Removing and installing additional brake light'*).

NOTICE

Components stored or set down incorrectly

- Risk of damage to component surfaces

⇒ Set the component down on a clean surface, workbench or assembly fixture.

3.4 Complete new rear spoiler

3.4.1 Remove additional brake light from the old lid (⇒ *Workshop Manual '947019 Removing and installing additional brake light'*).

3.4.2 Check that coding of connector housing for wire harness for additional brake light matches the removed additional brake light (air intake grille).
To do this, connect connectors for wire harness for additional brake light/removed additional brake light (air intake grille).

If the connectors cannot be connected:

Remove connector housing for additional brake light from wire harness for standard rear spoiler and install it on new wire harness for rear spoiler (⇒ *Figure 12*).

- 1 – Connector housing for additional brake light
- 2 – Secondary lock
- 3 – Line with single-wire seal and socket

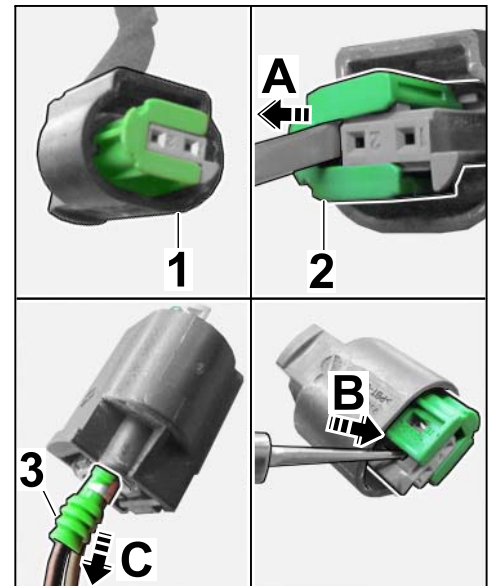

Figure 12

- 3.4.3 Guide connector for additional brake light (⇒ *Figure 13-2-*) in the rear spoiler to the cut-out for the additional brake light.

- 1 – Underside of rear spoiler
- 2 – Connector for additional brake light
- 3 – Connector for additional brake light/mounting bracket
- 4 – Clamp, 8.0 x 10.2/2.0
- 5 – Additional brake light

Fit retaining clip for wire harness for additional brake light in the rear spoiler (1 x ⇒ *Figure 13-A-*).

Route wire harness for additional brake light in the cable guide (underside of rear spoiler) and secure with three retaining clips (⇒ *Figure 13-arrows-*).

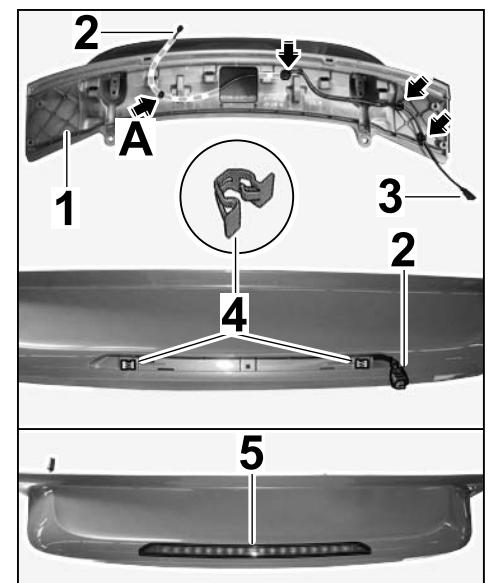

Figure 13

NOTICE

Incorrect procedure

- Risk of damage to paintwork

- ⇒ Do not use tools with sharp edges.
- ⇒ Cover the area you are working on.
- ⇒ Do not use aggressive cleaning agents/solvents.

3.4.4 Fit two clamps (8.0 x 10.2/2.0; ⇒ *Figure 13-4-*) in the new rear spoiler.

Install additional brake light on new rear spoiler (⇒ *Figure 13-5-*, ⇒ *Workshop Manual '947019 Removing and installing additional brake light*).

3.4.5 Fit two rubber mountings (19 x 5 x 2 for Carrera 2 or 19 x 2 x 2 for Carrera 4); (right: ⇒ *Figure 14*).

- 1 – Rubber mounting, 19 x 5 x 2 (Carrera 2)
- 2 – Buffer, 6 x 14.5 x 20
- 3 – Underside of rear spoiler

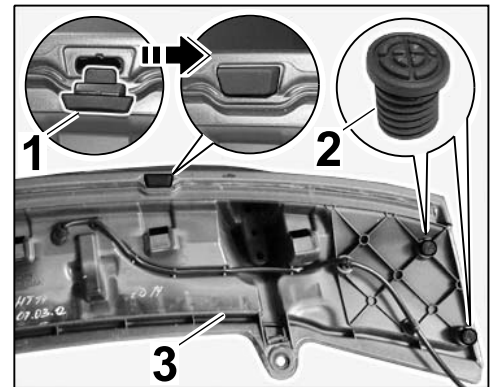

Figure 14

3.4.6 Screw buffer (6 x 14.5 x 20; 2 x left / 2 x right: ⇒ *Figure 14*) as far as it will go into the rear spoiler. Then unscrew each buffer by one turn.

3.5 Fit mounting bracket on the vehicle (⇒ *Workshop Manual '66581905 Removing and installing rear spoiler*).

- 1 – Mounting bracket
- 2 – Screw with washer assembly, M8 x 30
- 3 – Screw with washer assembly, M5 x 40
- 4 – Oval-head screw, M4.8 x 19

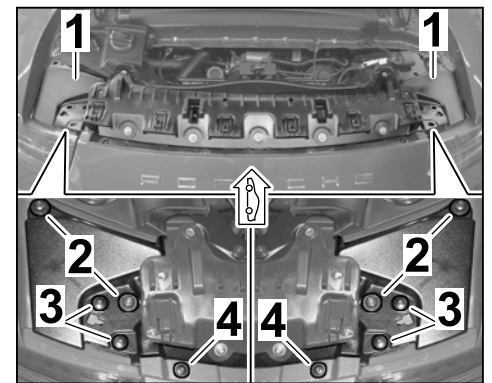

Figure 15

- Screw with washer assembly, M8 x 30: **Tightening torque 23 Nm (17 ftlb.)**
- Screw with washer assembly, M5 x 40: **Tightening torque 23 Nm (17 ftlb.)**
- Oval-head screw, M4.8 x 19: **Tightening torque 3.2 Nm (2.5 ftlb.) +/- 0.6 Nm (+/- 0.5 ftlb.)**

3.6 Connect electric plug connection for the main wire harness in the engine compartment and secure plug connection on the mounting bracket again if necessary.

3.7 Fit rear spoiler

- 1** – Underside of rear spoiler
- 2** – Upper side of mounting bracket
- A** – Pin
- a** – Corresponding groove
- B** – Lock pin
- b** – Corresponding lock groove

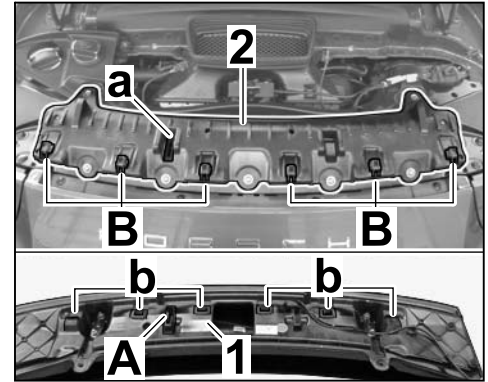

Figure 16

- 3.7.1 Carefully position rear spoiler over the mounting bracket and guide the pin (underside of rear spoiler) into the mounting bracket (⇒ Figure 17-A-).

- 1** – Pin (underside of rear spoiler)
- 2** – Mounting bracket
- 3** – Rear spoiler
- 4** – Bead on wing

- 3.7.2 Press rear spoiler down and carefully pull it as far as it will go to the rear at this position (⇒ Figure 17-B-).

The edges/radii all around the rear spoiler are flush with the edges/radii all around the wing (left/right: ⇒ Figure 17-C-).

- 3.7.3 Press rear spoiler down at the screw points and check gap dimensions to adjacent accessories.

Unscrew or screw in buffer (6 x 14.5 x 20; underside of rear spoiler) if necessary. Adjust gap dimensions as described in the Workshop Manual.

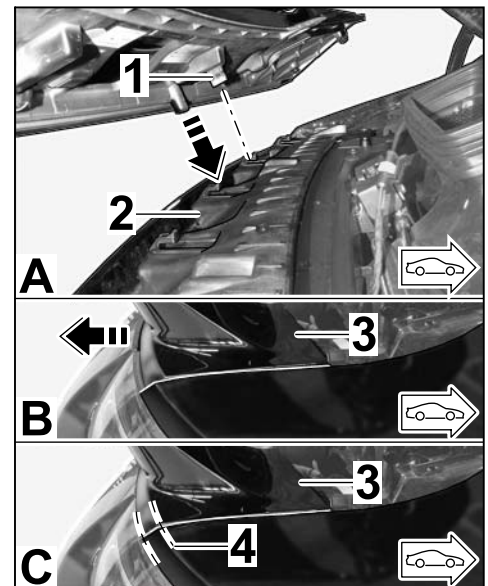

Figure 17

3.7.4 Insert two collar bore bushes (20 x 7 x 7.5) in the rear spoiler (⇒ *Figure 18*).

- 1 – Collar bore bush, 20 x 7 x 7.5
- 2 – Rear spoiler

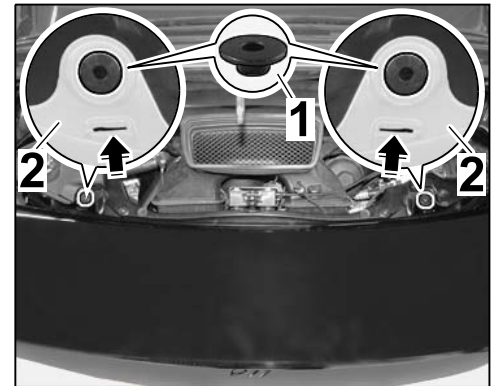

Figure 18

3.7.5 In the viewing window (⇒ *Figure 18* -arrows-), check whether the rear spoiler is touching the lock (mounting adapter).

Pull the rear spoiler as far as it will go to the rear again if necessary.

3.7.6 Tighten rear spoiler using two new combination screws (M6 x 35 TC).

Tightening torque 9.7 Nm (7.5 ftlb.)

3.7.7 Connect and secure electric plug connection for additional brake light.

3.7.8 Install engine-compartment blower and covers (⇒ *Workshop Manual '198119 Removing and installing engine-compartment blower*).

4 Concluding work

4.1 **9900 - PIWIS Tester 3** must be connected before switching on the ignition.

NOTICE

Voltage drop

- Risk of irreparable damage to control unit
 - Risk of damage to control unit
 - Fault entries in the control unit
 - Coding in the control unit is aborted
 - Malfunctions in control unit, even during programming
- ⇒ Switch off the ignition and remove the ignition key before disconnecting the control unit.
- ⇒ Ensure that the power supply is not interrupted during programming.
- ⇒ Connect a battery charger with a current rating of at least Nominal value 70 A to the vehicle battery.

NOTICE

Control unit programming will be aborted if the Internet connection is unstable.

- **An unstable Internet connection can interrupt communication between PIWIS Tester II and the vehicle communication module (VCI). As a result, control unit programming may be aborted.**
- ⇒ **During control unit programming, always connect PIWIS Tester II to the vehicle communication module (VCI) via the USB cable.**



Information

The **9900 - PIWIS Tester 3** instructions take precedence since the description may be different with later Tester releases.

The procedure described here has been structured in general terms; different text or additions may appear on the **9900 - PIWIS Tester 3**.

- 4.2 **ONLY** for vehicles with sliding roof/glass sunroof:
Program new control unit for air deflector (⇒ *Workshop Manual '606655 Replacing control unit for air deflector*).
- 4.3 Enter "SportDesign package" in the vehicle data.
 - 4.3.1 Select the required vehicle type. Press •F12" to continue.
 - 4.3.2 Press •F7" in the control unit overview to switch to the "Additional menu".
 - 4.3.3 Select the "Maintenance of vehicle data" function. Press •F12" until "X numbers" appears in the Value group column.
 - 4.3.4 Scroll to "SportDesign package" in the "Family" column, select "XAT – SPORT DESIGN PACKAGE 911" there and press •F8" to save your selection.
Press •F12" as soon as the message "Modified values have been buffered" appears.
 - 4.3.5 Press •F12" until modified values are displayed. Save the values by pressing •F8" .
 - 4.3.6 Wait until the message "Generation of the vehicle order is complete" appears. Continue to Log management by pressing •F12" .
 - 4.3.7 Press •F10" to open the log. Check that vehicle equipment "XAT – SPORT DESIGN PACKAGE 911" has been entered and close the log.
- 4.4 Code the new vehicle equipment.
 - 4.4.1 Switch to the "Codings/adaptations" menu and select "Automatic coding with coding rules". Press •F12" to continue.
 - 4.4.2 Select all control units in the control unit overview (•CTRL+A") and switch to the "Codings/adaptations" column.
 - 4.4.3 Select Automatic coding. Press •F12" to continue.

- 4.5 Once coding is completed successfully: Read out the fault memory of all systems, work through any existing faults and erase the fault memory (⇒ *Workshop Manual '033500 Fault memory for on-board diagnosis*).
- 4.6 Check function of lights, particularly the additional brake light.
- 4.7 Switch off ignition and disconnect **9900 - PIWIS Tester 3**.
- 4.8 Disconnect the battery charger (⇒ *Workshop Manual '2X00IN Battery trickle charging*) and drive the vehicle off the lifting platform.

66 58 61 91: –Rear spoiler (SportDesign package), new part painted– Labor time: **70 TU**
Includes: Materials: 7 MU
Without: Paint preparation (separate LO No.)!

66 56 61 51: –Air intake grille (rear lid), new part painted– Labor time: **50 TU**
Includes: Materials: 4 MU
Without: Paint preparation (separate LO No.)!

66 99 61 72: –SportDesign package complete (rear spoiler and air intake grille), new part painted– Labor time: **120 TU**
Includes: Materials: 11 MU
Without: Paint preparation (separate LO No.)!

51 01 71 05: –Preparing body paintwork– Labor time: **130 TU**
Includes: Order-based;
Painting of new parts, Step 1;
Plastic part

66 99 31 13: –SportDesign package installed– Labor time: **249 TU**
Includes:
Removing and installing rear spoiler and air intake grille, completing new rear spoiler and adjusting rear spoiler.
Testing front lights and 3rd brake light.
Programming “SportDesign package – XAT” option and removal of a 3rd brake light.

60 66 55 00: **ONLY** for vehicles with sliding roof = I-no. 651/glass sunroof = I-no. 653:

–Replacing control unit for air deflector–

Labor time: **167 TU**

Includes: Headliner removed and installed, control unit for air deflector replaced.
New control unit for air deflector programmed.

Important Notice: Technical Bulletins issued by Porsche Cars North America, Inc. are intended only for use by professional automotive technicians who have attended Porsche service training courses. They are written to inform those technicians of conditions that may occur on some Porsche vehicles, or to provide information that could assist in the proper servicing of a vehicle. Porsche special tools may be necessary in order to perform certain operations identified in these bulletins. Use of tools and procedures other than those Porsche recommends in these bulletins may be detrimental to the safe operation of your vehicle, and may endanger the people working on it. Properly trained Porsche technicians have the equipment, tools, safety instructions, and know-how to do the job properly and safely. If a particular condition is described, do not assume that the bulletin applies to your vehicle, or that your vehicle will have that condition. See your authorized Porsche Dealer for the latest information about whether a particular technical bulletin applies to your vehicle. Part numbers listed in these bulletins are for reference only. Always check with your authorized Porsche dealer to verify the current and correct part numbers. The work procedures updated electronically in the Porsche PIWIS diagnostic and testing device take precedence and, in the event of a discrepancy, the work procedures in the PIWIS Tester are the ones that must be followed.

© Porsche Cars North America, Inc.

Dealership	Service Manager	Shop Foreman	Service Technician
Distribution			
Routing	Asst. Manager	Warranty Admin.	Service Technician

Dr. Ing. h.c. F. Porsche AG is the owner of numerous trademarks, both registered and unregistered, including without limitation the Porsche Crest®, Porsche®, Boxster®, Carrera®, Cayenne®, Cayman®, Macan®, Panamera®, Speedster®, Spyder®, 918 Spyder®, Tiptronic®, VarioCam®, PCM®, PDK®, 911®, RS®, 4S®, FOUR, UNCOMPROMISED®, and the model numbers and the distinctive shapes of the Porsche automobiles such as, the federally registered 911 and Boxster automobiles. The third party trademarks contained herein are the properties of their respective owners. Porsche Cars North America, Inc. believes the specifications to be correct at the time of printing. Specifications, performance standards, standard equipment, options, and other elements shown are subject to change without notice. Some options may be unavailable when a car is built. Some vehicles may be shown with non-U.S. equipment. The information contained herein is for internal authorized Porsche dealer use only and cannot be copied or distributed. Porsche recommends seat belt usage and observance of traffic laws at all times.

Printed in the USA